

# DC Immune CT

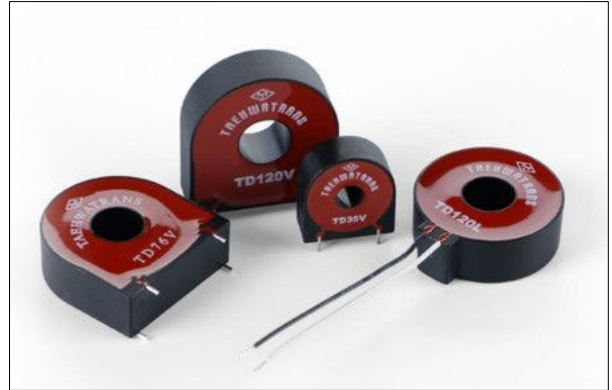

Taehwatrans DC immune CTs show the same level of reading accuracy in AC operating current and in half rectified DC component. What makes our CTs special compared to anti-tampering purpose-only DC immune CTs in the market is that Taehwatrans DC immune CTs are capable of measuring AC and DC component with high accuracy. The actual current loss keeps less than 0.1% and linearity shows less than 0.05% & 0.03 degrees. So even though it has intrinsic high phase displacement, it has an excellent accuracy to satisfy class 0.5 smart meters in addition to measuring multi harmonics in the high accuracy. The characteristics is the supreme linearity throughout the whole dynamic current range and very low current loss

## **Application**

- High end DC immune electronic energy meters
- Measurement of DC components in the AC line
- EV Charger (Stand/Cable)

## **General Features**

- Compliant to IEC 61869-2
- Excellent linearity & precision
- Good performance in DC factor
- Nearly same phase displacement throughout the whole dynamic current.
- High Potential voltage 2.5kV per min.
- UL Recognized
- RoHS compliant

# Drawing

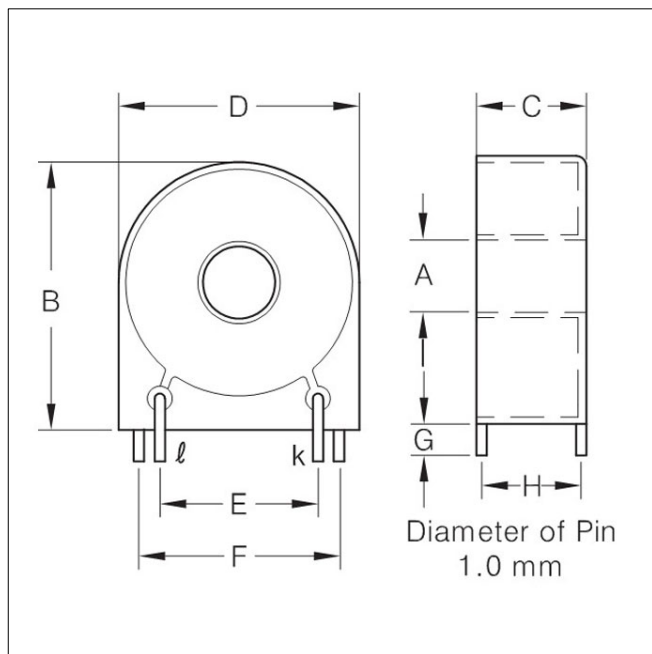

PCB Mountable Type

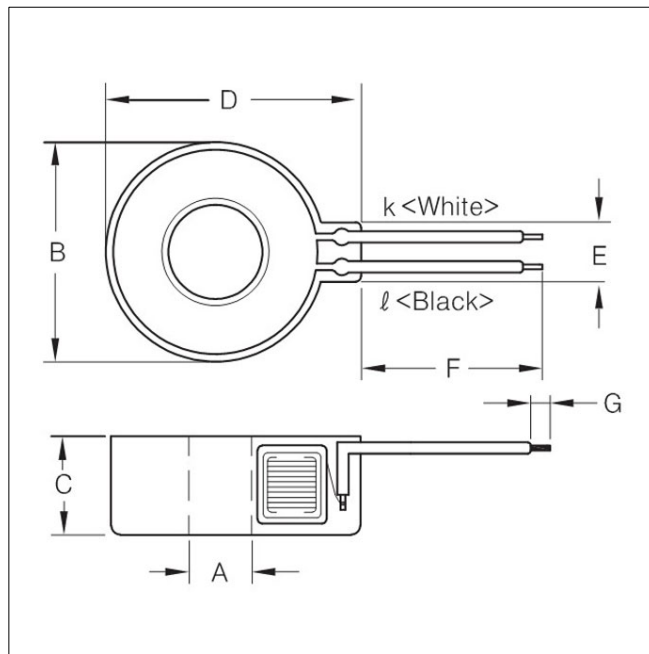

Wire Lead Type

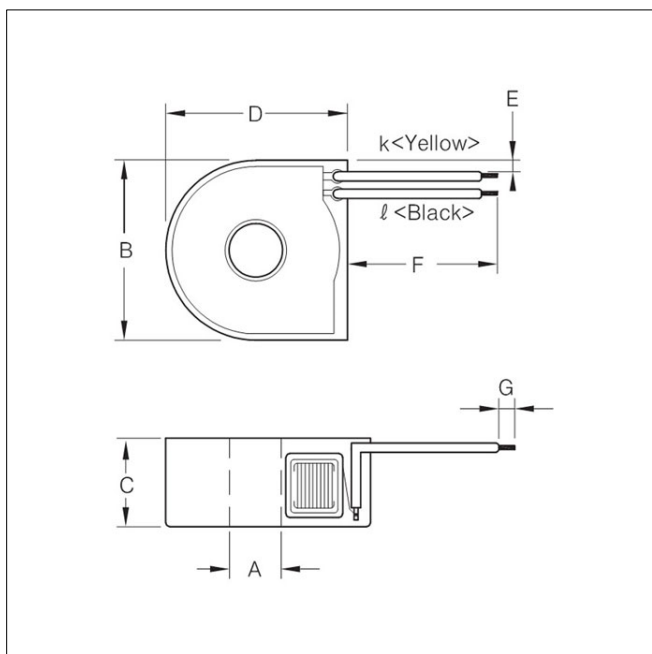

TD41L / TD121L

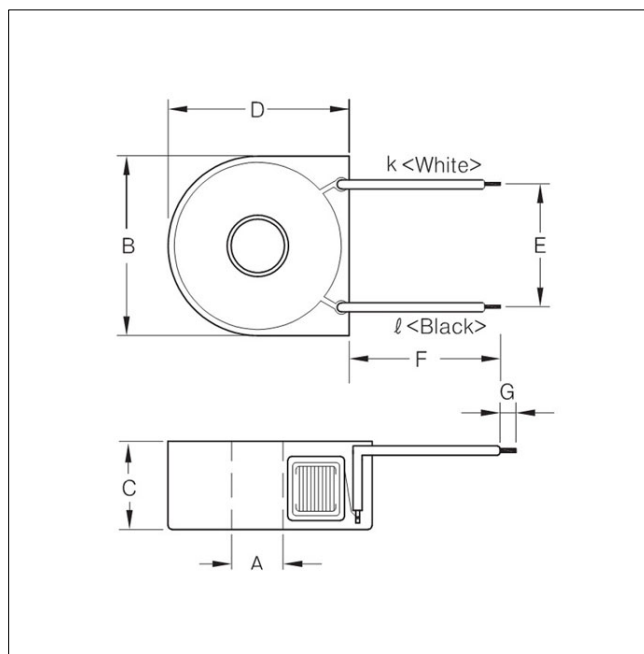

Lead Wire TD71L

# Electrical Property & Dimension

F : 50Hz

Model NO	Current Ratio	I <sub>max</sub>	I <sub>dc</sub>	DCR(Ω)	I <sub>p</sub> = 0.25A		I <sub>p</sub> =5A		Linearity @ 0.25-5A range		Dimensions(mm)			
				(±6%)	Ratio Error(%)	Phase Shift (min)	Ratio Error(%)	Phase Shift (min)	Ratio Error	Phase Shift	Window	Width	Height	Thickness
TD35VC	2500:1	72A	40A	107	-0.3±0.5	420'±30'	-0.3±0.5	417'±30'	0.1%	3'	6.8	23.5	25.0	11.0
TD35L	2500:1	72A	40A	107	-0.3±0.5	420'±30'	-0.3±0.5	417'±30'	0.1%	3'	6.8	26.8	23.6	11.0
TD40V	2500:1	80A	40A	98	-0.3±0.4	250'±20'	-0.3±0.4	250'±20'	0.1%	2'	8.9	25.3	27.5	17.0
TD40L	2500:1	80A	40A	98	-0.3±0.4	250'±20'	-0.3±0.4	250'±20'	0.1%	2'	8.9	25.3	27.5	17.0
TD61L	2500:1	72A	60A	61	-0.3±0.5	240'±25'	-0.3±0.5	240'±25'	0.1%	2'	8.0	31.5	30.5	15.0
TD120V	2500:1	180A	120A	51	-0.25±0.25	240'±25'	-0.25±0.25	200'±25'	0.1%	1'	12.9	38.0	39.3	14.0
TD120L	2500:1	180A	120A	51	-0.25±0.25	240'±25'	-0.25±0.25	200'±25'	0.1%	1'	12.9	41.3	37.5	14.0
TD77V	2500:1	72A	40A	85	±0.5	230'±20'	±0.5	220'±20'	0.1%	8'	6.8	23.5	25.0	11.0
TD77L	2500:1	72A	40A	85	±0.5	230'±20'	±0.5	220'±20'	0.1%	8'	6.9	26.8	23.6	11.0
TD71V/L	2500:1	80A	40A	100	-0.4±0.3	720'±50'	-0.4±0.3	720'±50'	0.1%	5'	11.2	26.9	28.7	17.0
TD76V	2500:1	180A	100A	41	-0.5±0.5	230'±20'	-0.5±0.5	230'±20'	0.1%	2'	12.9	38.0	39.3	14.0
TD76L	2500:1	180A	100A	41	-0.5±0.5	230'±20'	-0.5±0.5	230'±20'	0.1%	2'	12.9	41.3	37.5	14.0
TD41L	2500:1	72A	40A	149	-0.03±0.07	7'±5'	-0.03±0.07	5'±5'	0.1%	3'	8.5	31.6	30.1	18.9
TD121L	2500:1	120A	120A	85	-0.03±0.07	7'±5'	-0.03±0.07	5'±5'	0.1%	3'	11.0	37.8	35.7	15.6

\* V : PCB Mountable

\* L : Lead Wire

## Secondary Burden & Output Voltage Graph

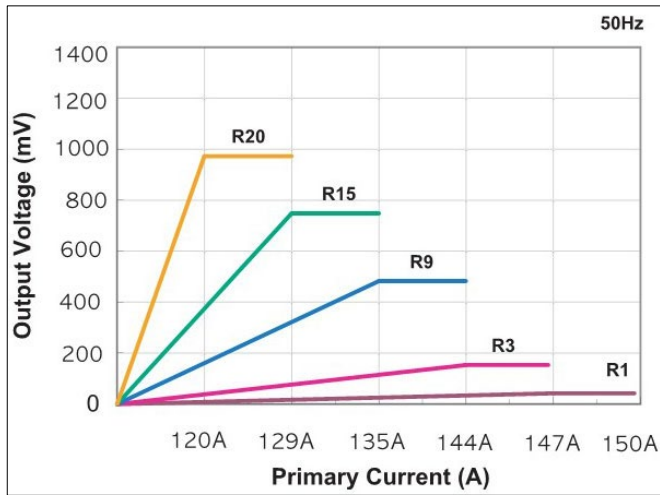

TD35VC/L

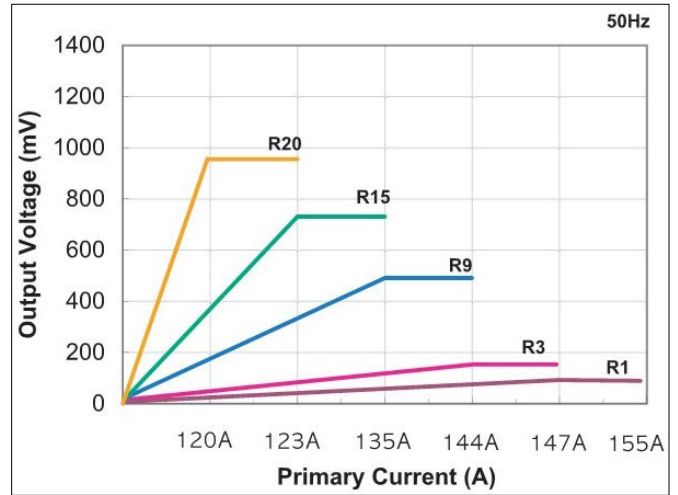

TD40V/L

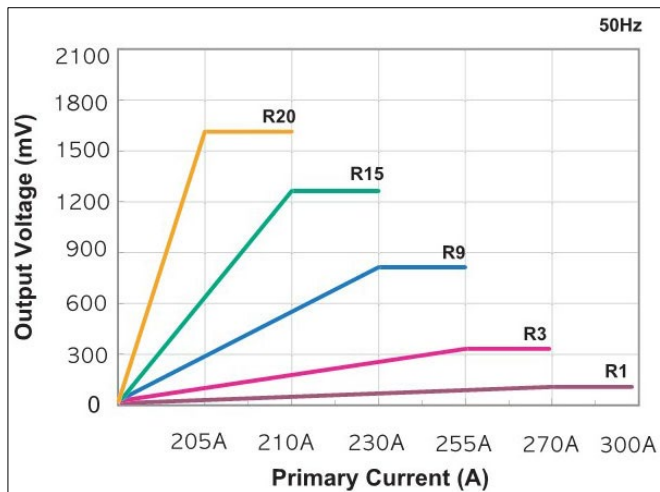

TD61L

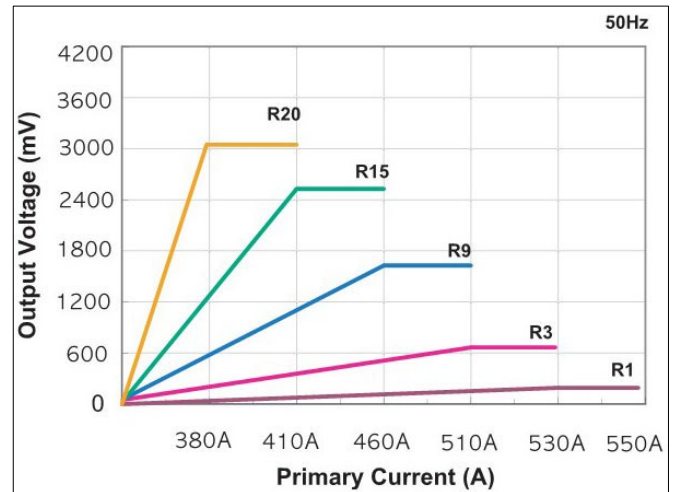

TD120V/L

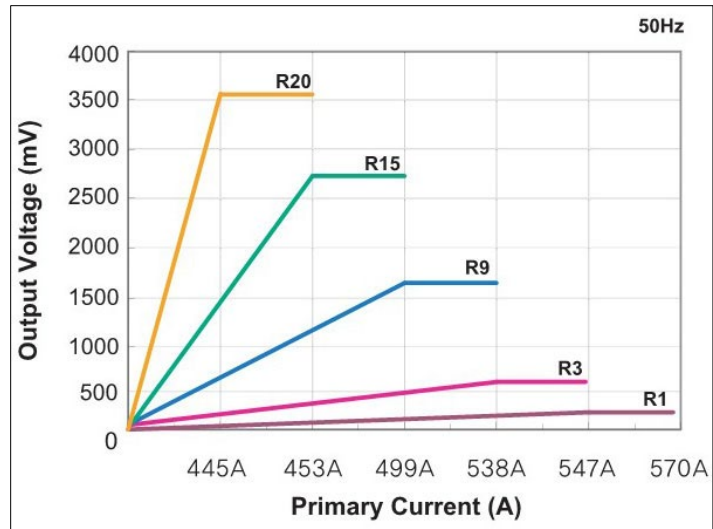

TD121V/L



ASRAS CO.,LTD  
1694, 1694/1 Prachasongkhro Road Dingdaeng,  
Dindaeng, Bangkok 10400 Tel.  
02-277-9969, Fax 02-277-0995

E-mail : sales@asras.co.th  
Website : www.asras.co.th

Distribution in Thailand by ASRAS Co.,Ltd.